



PLEASE READ BEFORE USE

integral™ LED

IP20

Integral LED RF Colour Temperature Change Wall-mounted Touch Remote ILRC021



**THE WALL-MOUNTED TOUCH REMOTE IS A 100-240V AC INPUT PRODUCT.
DO NOT INSTALL PRODUCT WITH METAL BOX WHICH CAN AFFECT THE SIGNAL TRANSMISSION.
SWITCH OFF POWER BEFORE CONNECTING THE PRODUCT TO A MAINS SUPPLY.**

IMPORTANT NOTICE

- This product should be installed according to the instructions in this guide and by a qualified electrical installer.
- All electrical work must be completed in accordance with the latest IET wiring regulations (formally IEE) for the UK or in accordance with all applicable regulations and laws in the country in which it is being installed.
- Switch OFF power at the mains before installing the product.
- Always disconnect or switch off the power supply before making any adjustment to the wiring.
- Observe the operating temperature of the product: -20°C to 50°C
- Limited 5 Year Warranty. This LED wall-mounted touch remote is for indoor use only. Improper installation, abuse or miss-powering of the wall-mounted touch remote and receiver or failure to use the wall-mounted touch remote and suitable receiver for its intended use will void the warranty. Proof of purchase is required for all returns. Your statutory rights remain unaffected.

Please see www.integral-LED.com/warranty.
Questions? Please contact your supplier or see integral-LED.com

1. INTRODUCTION

The Integral LED RF colour temperature change wall-mounted touch remote is designed to work with the Integral LED receiver (ILRC014) and colour temperature change strip. The wall-mounted touch remote can be used to control four zones of strip lighting. You will be able to

switch on/off, change the colour temperature of the strip and dim the strip to your ideal level for each independent lighting zone. You can change the mood and look of your space instantly.

2. PARAMETER

- Control interface: Touch control
- Input Voltage: 100-240V AC
- Power Consumption: 20mA
- Output: RF signal
- Working Frequency: 868MHz
- For use with ILRC014 RF receiver
- Control: Colour temperature change
- Control Zone: 4 zones synchronously and independently
- Remote Distance: 20-30 metres
- IP rating: IP20
- Working Temperature: -20°C to 50°C
- Relative Humidity: 8% to 80%
- Product Colour: White (ILRC021) interface available
- Dimensions: L86xW86x29.1(mm)
- Weight (N.W.): 200g

3. OPERATING INSTRUCTIONS

A. Matching the RF Receivers with Colour Temperature Change Wall-mounted Touch Remote

The RF colour temperature change wall-mounted touch remote (ILRC021) is designed to be used with the RF receiver (ILRC014). You will need to match the receivers before starting to use wall-mounted touch remote.

Match the RF receiver with the "Learning Key" on the receiver(s).

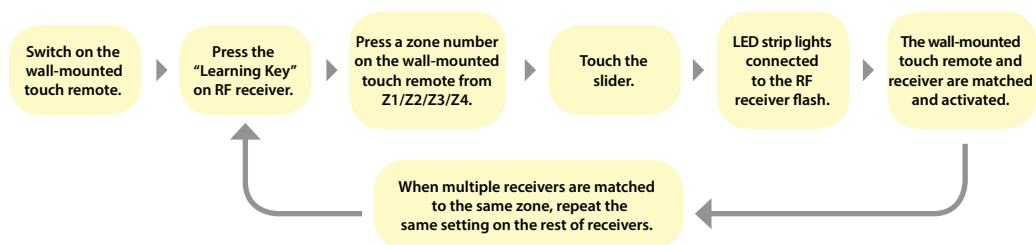

Alternative way to match RF receiver when it is difficult to access the receivers.

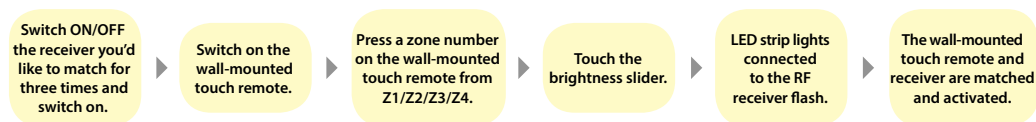

One receiver can be matched up to a maximum of 8 wall-mounted touch remotes.

To cancel the matching: Press "Learning Key" button on the receiver for more than 3 seconds until the LED strip lights connected to the receiver flash.

B. Operating the Wall-mounted Touch Remote

For all operation, first select a zone number from Z1, Z2, Z3 and Z4, then follow the instruction below to activate the selected zone.

ON/OFF INDICATOR: Blue light is ON, Yellow light is OFF (standby).

When Yellow light is on (standby), touch ON/OFF before operating and the indicator will change to Blue light.

ON/OFF: Touch to switch ON/OFF for all zones.

SWITCH : To control SLIDER and toggle between colour temperature or brightness.

SLIDER: Touch to select colour temperature or brightness.

SAVE scene setting. (Saves a scene setting across all zones)

e.g. S1 to be set as morning mode – white light and 100% brightness. S2 to be set as evening mode – warm light and 100% brightness. Touch S1 to change all zones to white light and 100% brightness. Touch S2 to change all zones to warm light and 100% brightness.

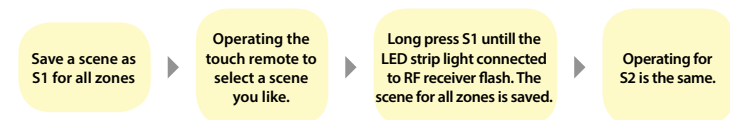

RECALL the saved scene setting.

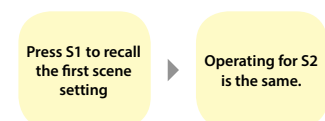

Front of the wall-mounted touch remote

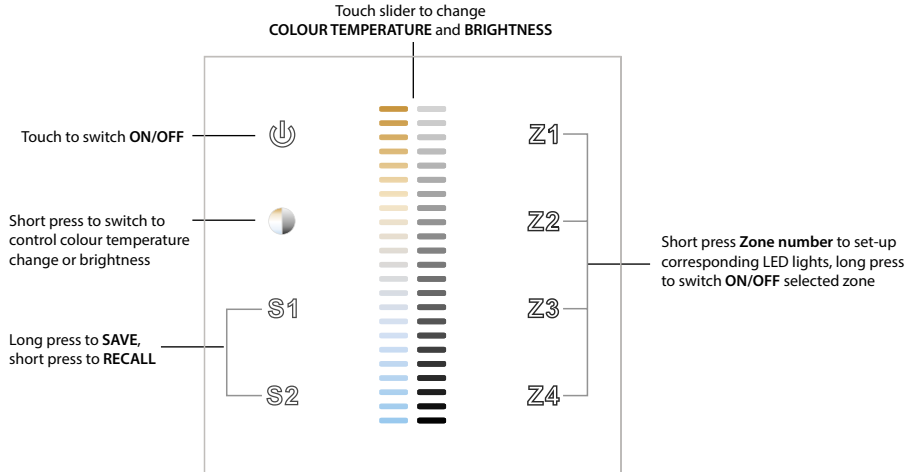

Back of the wall-mounted touch remote

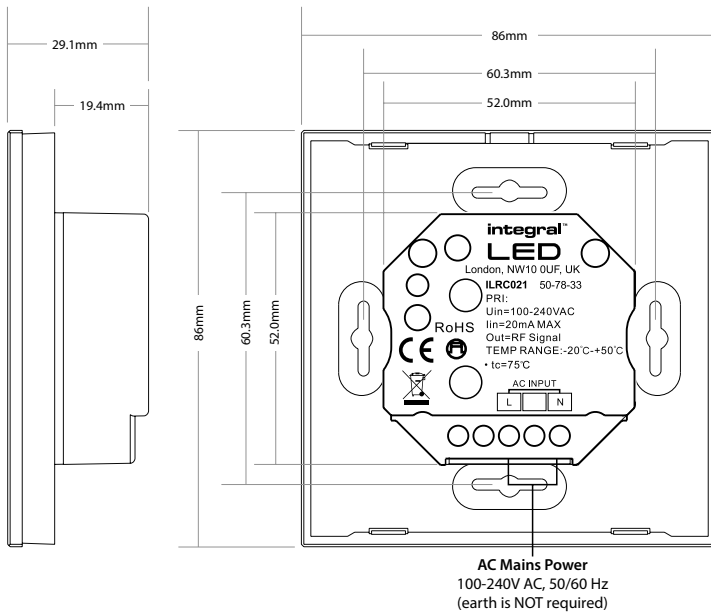

C. Installation - Wiring diagram

This wall-mounted touch remote requires 100-240V AC 50/60 Hz mains power and fits a standard single pattress/back box with minimum depth of 25mm.

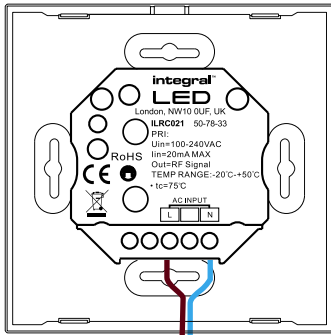

N (Neutral-Blue)
L (Live-Brown)



Mains power
100-240V AC, 50/60 Hz
(earth is NOT required)

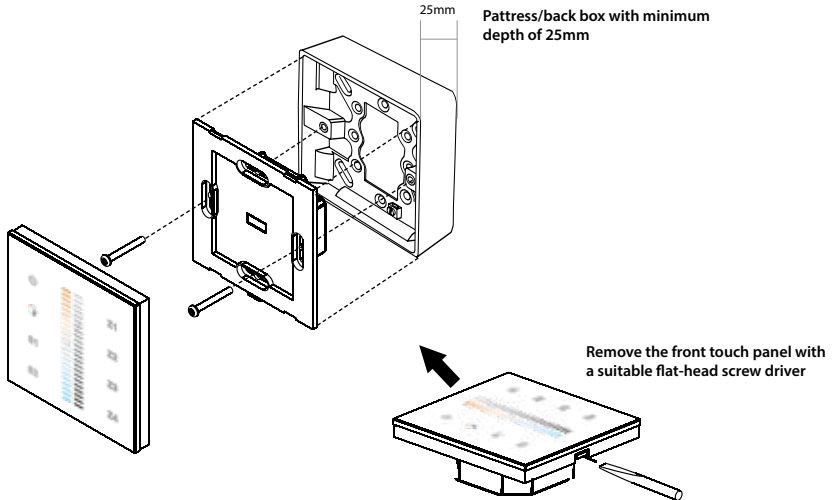

Pattress/back box with minimum
depth of 25mm

Remove the front touch panel with
a suitable flat-head screw driver



WASTE ELECTRICAL PRODUCTS SHOULD NOT BE DISPOSED OF WITH HOUSEHOLD WASTE. PLEASE RECYCLE WHERE FACILITIES EXIST. CHECK WITH YOUR LOCAL AUTHORITY FOR RECYCLING ADVICE.

Integral LED is a division
of Integral Memory plc:
Unit 6 Iron Bridge Close,
Iron Bridge Business Park,
London, NW10 0UF, UK